



PRODUCT

DC 800

Alternator Charger



Specifications(Mode)

Specifications	Type	
Charge	Input	12Vdc/24Vdc(11Vdc-31Vdc)
	Output	40Vdc-60Vdc, Max 800W
Reverse charge	Input	44.6Vdc-60Vdc
	Output	14.2Vdc/27.6Vdc, Max 800W
Battery maintenance	Input	44.6Vdc-60Vdc
	Output	14.2Vdc/27.6Vdc, Max 100W

Specifications(General Info)

Information	
Rated Current of Fuse Cable	125A
Cable Gauge	6AWG (13.3mm ²)
Protection type	Overcurrent protection/short circuit protection/overvoltage protection/ Undervoltage protection/high temperature protection/low temperature protection
Operating temperature	-4°F ~140°F (-20°C~60°C)
Storage temperature	-22°F ~158°F (-30°C~70°C)
Storage humidity	≤95%
Dimensions	10.73*6.0*3.13in (272.5*152.5*79.6mm)
Net weight	2.45lb (1.11kg)

Overview

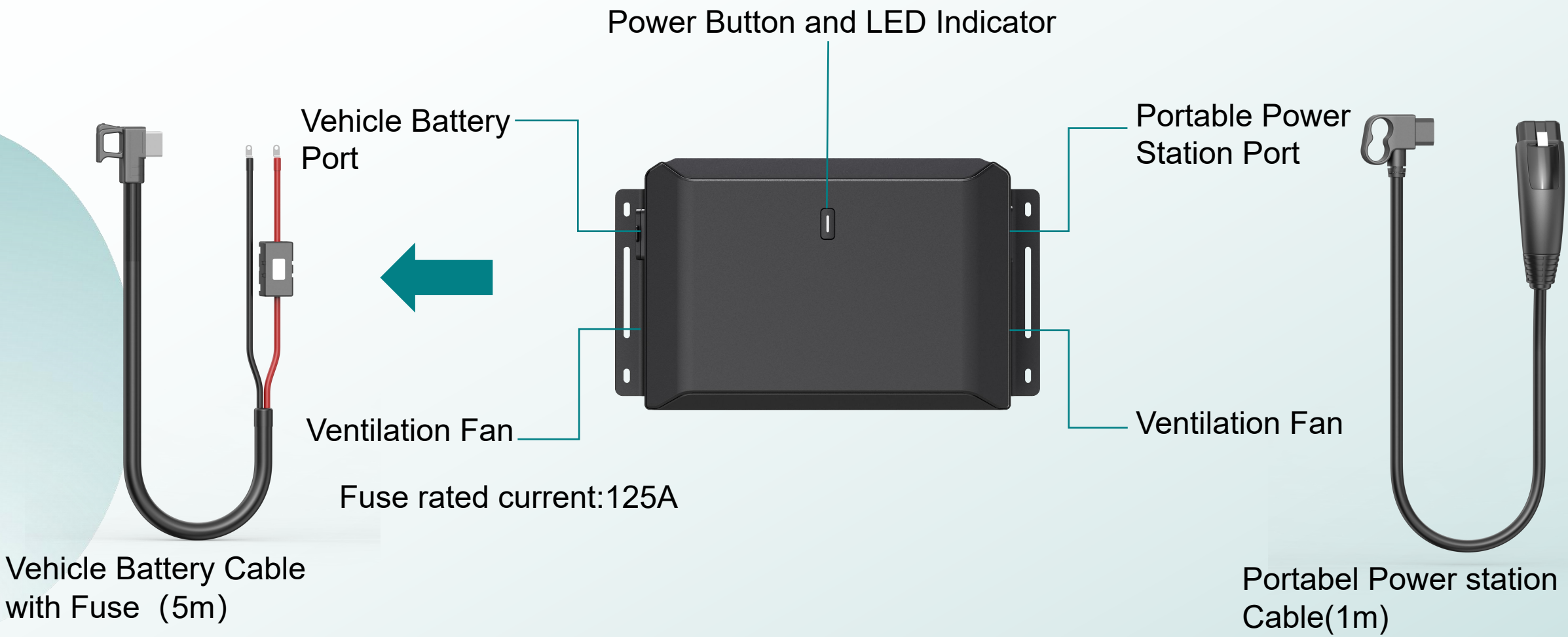

LED Indicator

Color	State	Indication
Green	Solid	In Charge Mode
	Flash	Charge Mode in standby
White	Solid	In Reverse Charge Mode
	Flash	Reverse Charge Mode in standby
Blue	Solid	In Battery Maintenance Mode
	Flash	Battery Maintenance Mode in standby
Red	Solid	Error Warning. Check APP for details.
	Flash	Disconnecting from APP, quick flash indicates disconnecting and slow flash indicates successful disconnection

Connect

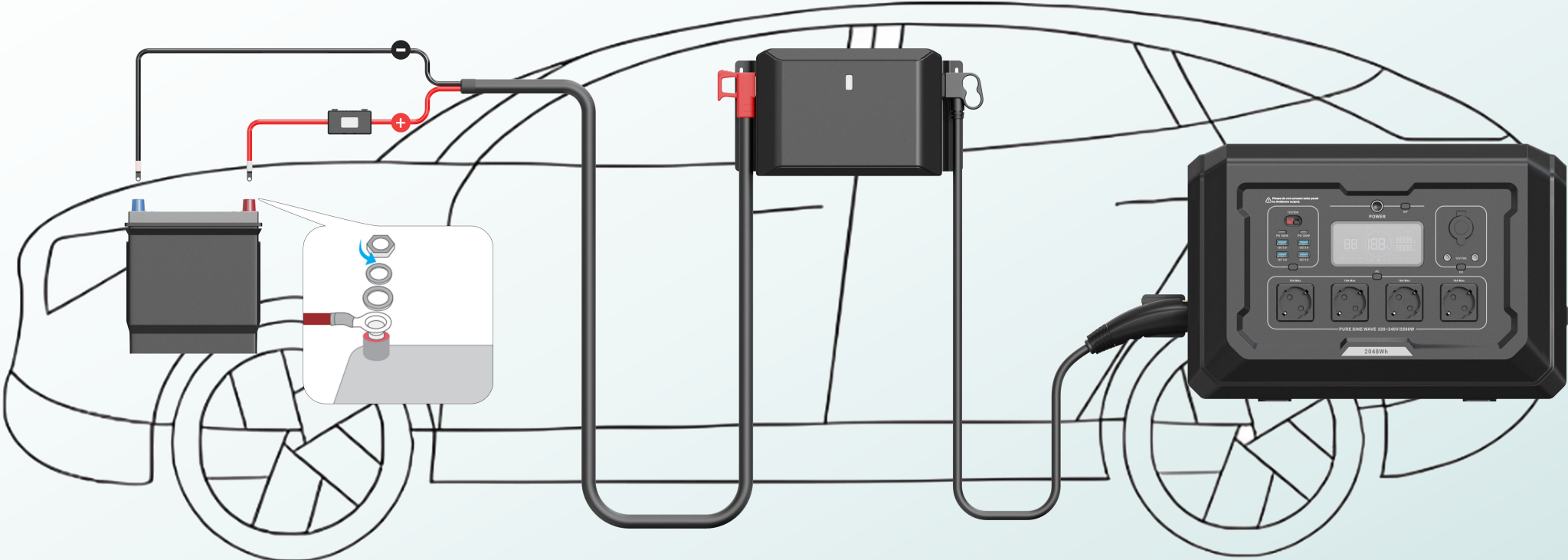

Fix

Method 1: Drill M4.2 self-tapping screws into the car body to fix it

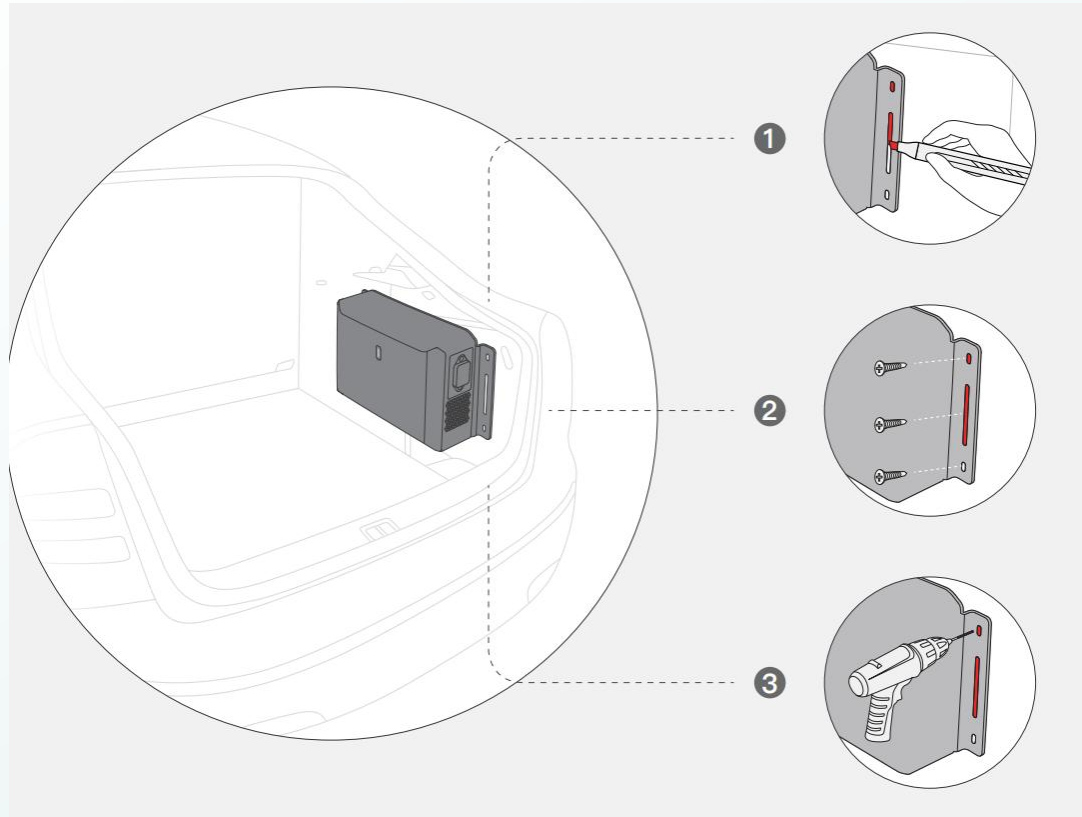

Method 2: Drill 4mm holes, fix M4 bolts + nuts on the board, and fix the board on the car.

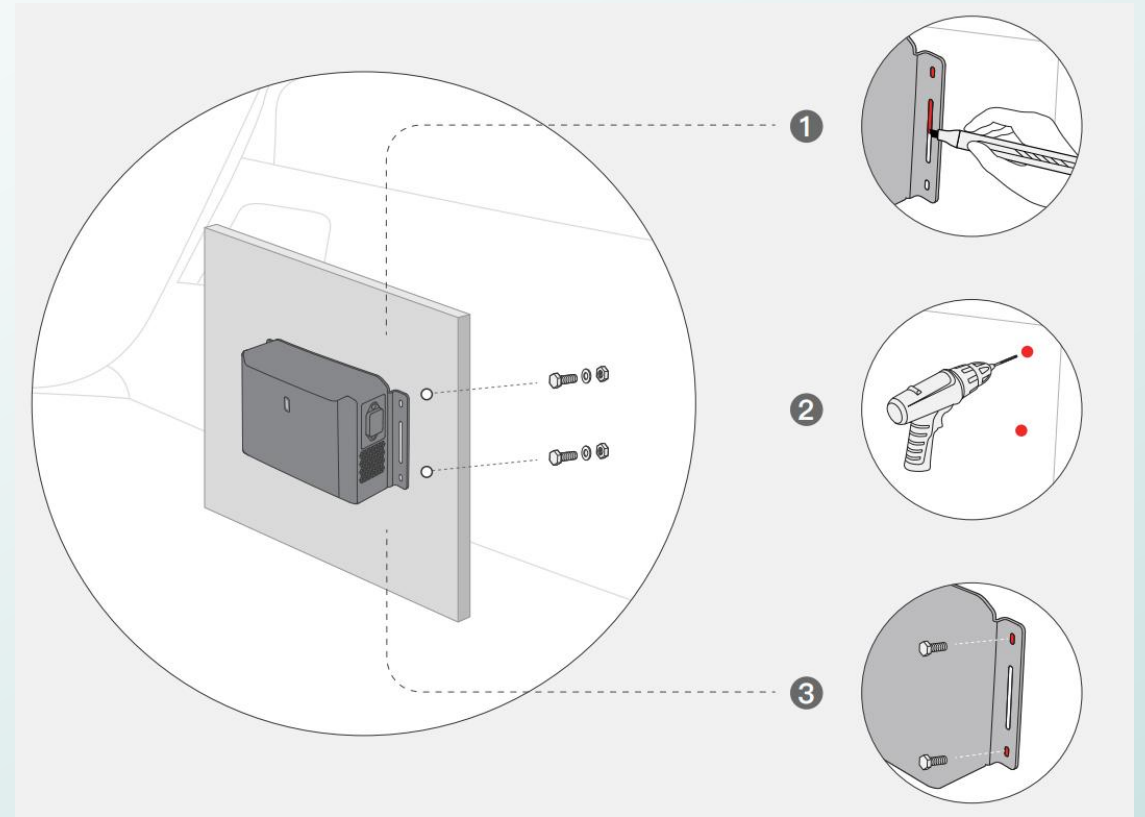

Instructions

1. Power on: Short press for 1 second, the indicator light turns green
2. Working status: Press the short twice to start or stop working in the power-on state.
3. Switch mode: In the power-on state, short press for 1 second.
4. Power off: Long press for 3 seconds, and the indicator light turns off.
5. Download APP: Turn on the bluetooth. Connect the alternator charger to the APP, following the steps on APP.

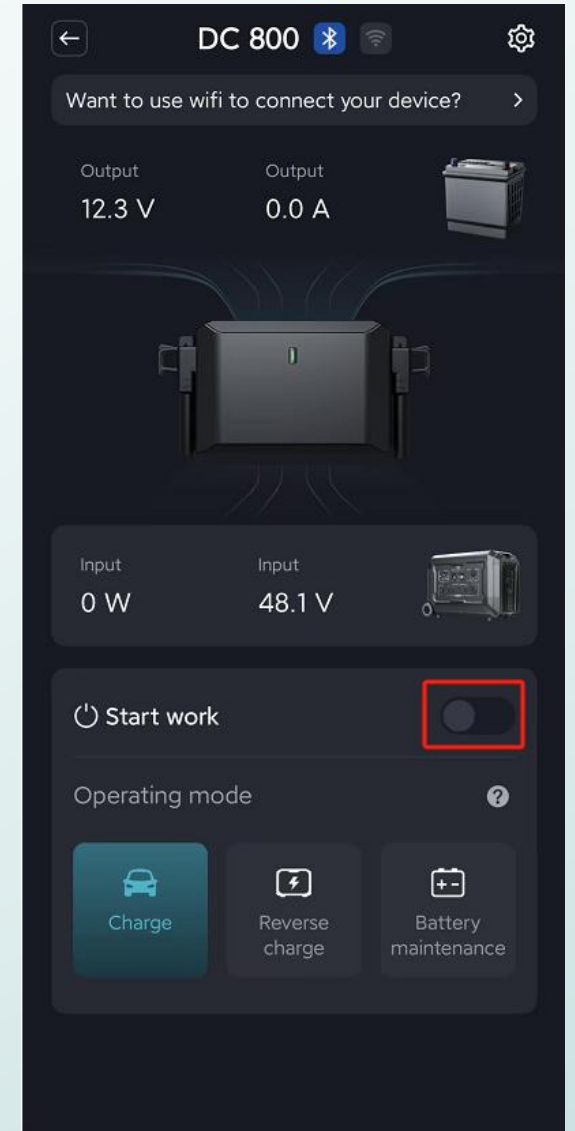
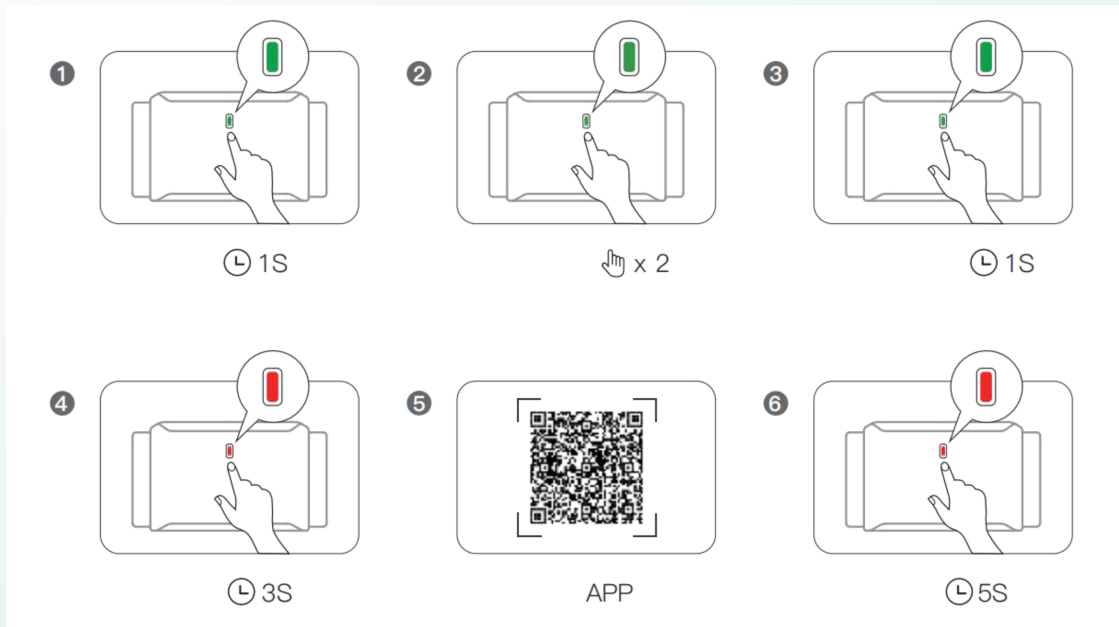

Instructions

6. Unbinding:

Method 1: DC800- Press and hold the indicator light for 5 seconds, the indicator light flashes red

Method 2: APP--Homepage--My Devices--Press and hold to unbind.

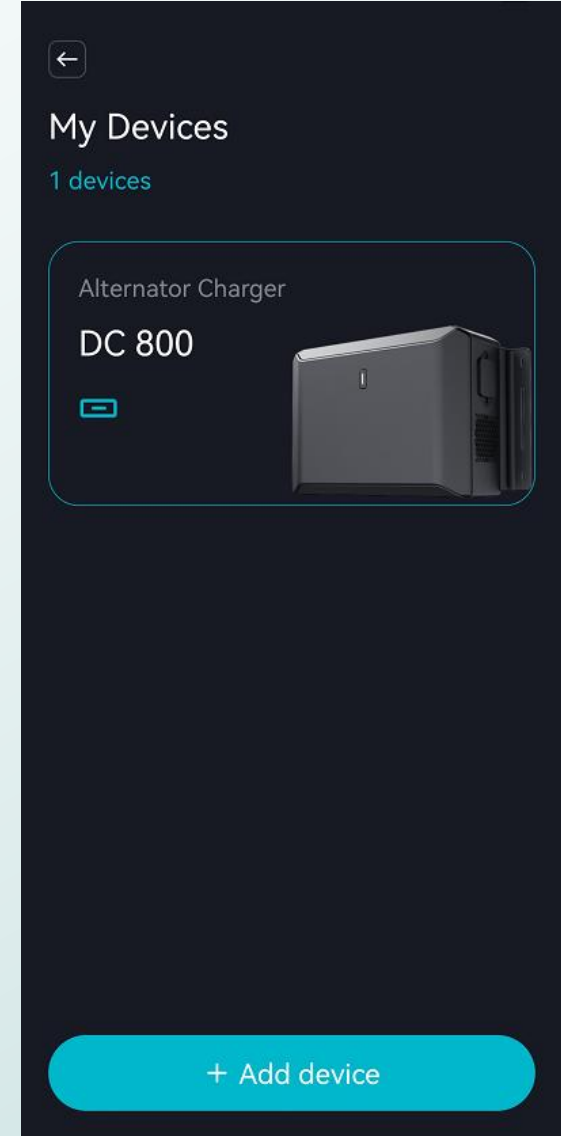
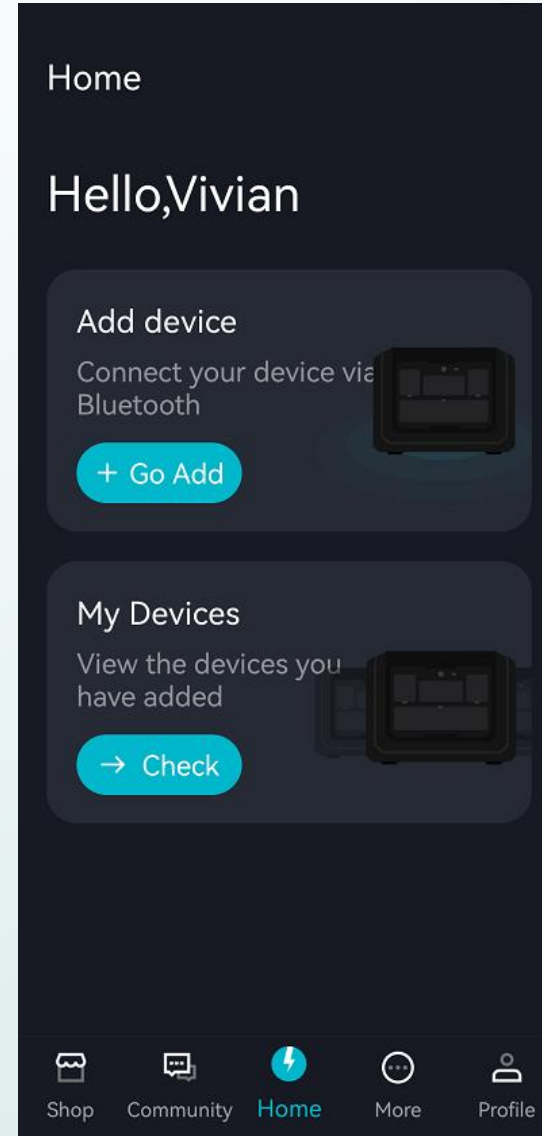
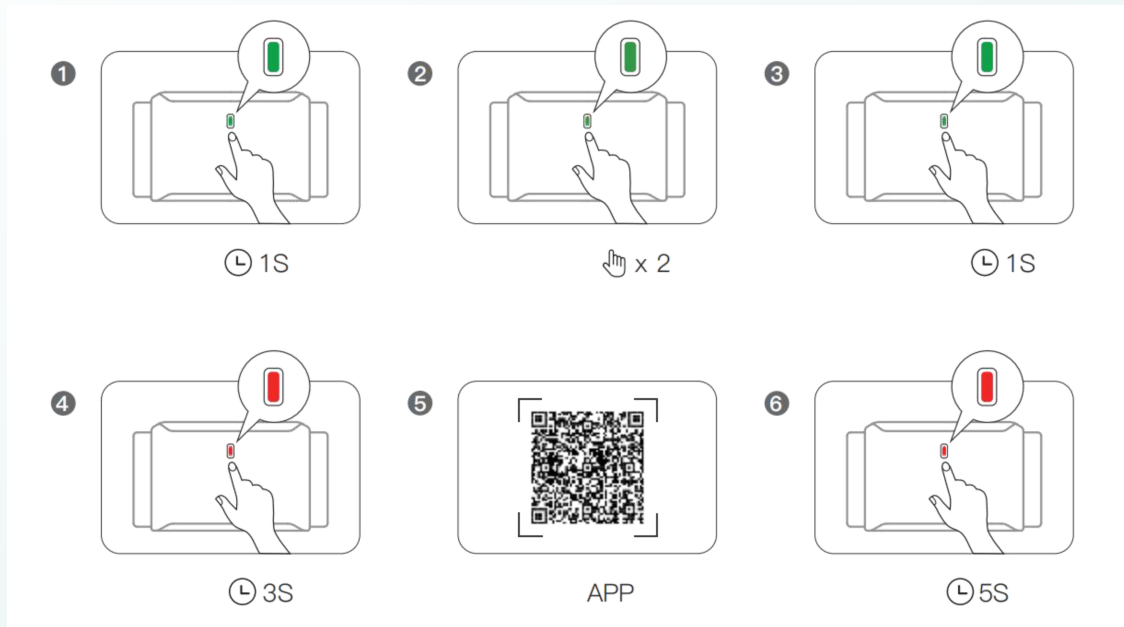

Three Working Mode

1. Charging mode

Indicator light: green

Maximum power: 800W

Car batteries and RV batteries need to be 12V or 24V

After charging starts, it defaults to a low-power 200W pre-charging mode to facilitate subsequent full charging of the power station. The charging power can be adjusted after 1 minute.

In charging mode, the actual charging power depends on the driving status and model of the vehicle.

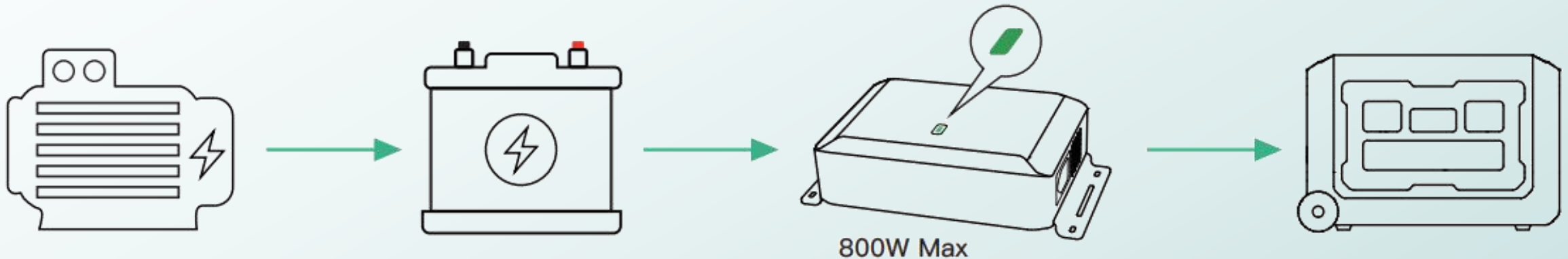

Three Working Mode

2. Reverse charging mode (power station charges car battery)

Indicator light: white

Maximum power: 800W

After charging starts, it enters the low-power 200W pre-charging mode by default, which is convenient for the power station to fully charge later. The charging power can be adjusted after 1 minute.

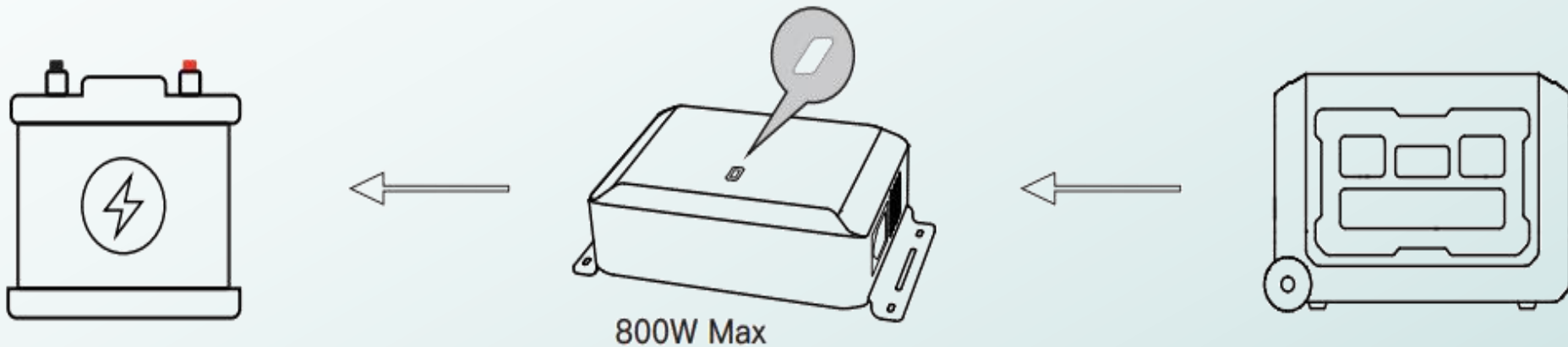

Three Working Mode

3. Battery maintenance mode

(The power station charges the infrequently used car battery)

Indicator light: blue

Maximum power: 100W

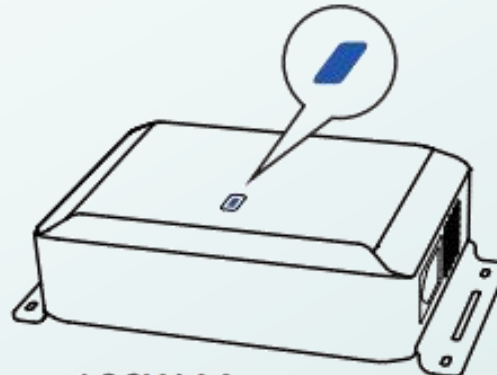
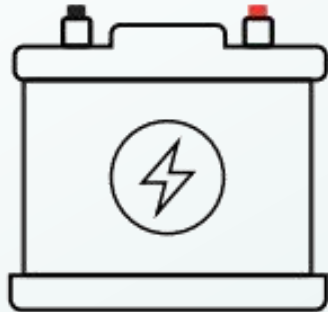

100W Max

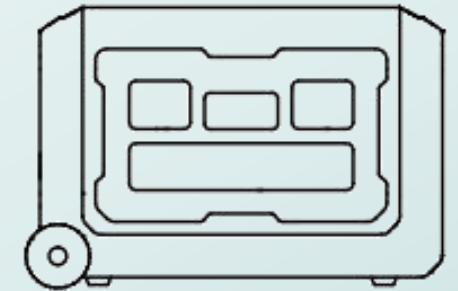
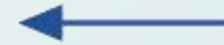

Compatibility

Model	Compatible
S1	√
S2	√
S3	√
S5	√
W3	√
W5	√
S2-BAT	√
S5-BAT	√
S012	×
S015	×
S024	×